

**结构特点 Design features**

- 内装、单端面、波形弹簧、平衡型、销钉传动结构，任意旋向，弹性元件不与介质接触，抗阻塞能力强。
- 安装尺寸符合ISO3069、DIN24960和GB6556标准。
- Internally mounted, single face, with Super-Sinus spring, balanced structure, and driven by spina, any rotation direction, spring no-touch to media, has a stronger antiblocking condition.
- Conform to the standard of DIN24960, ISO3069 and GB6556.

密封型号一览表(根据动环组件及材料配对进行分类而得)  
Table of seal types (According to the materials and rotary unit categorization)

动环组件 Rotating unit		静环 Stationary ring	
		G16	G46
名称 Name	密封面材质 Materials	Q1、V	Q12
HJ92	A、B	HJ92N	—
HJ97G	Q12	—	HJ977GN



**适用范围 Operating limits**

- 压力 Pressure: ≤2.5MPa
- 温度 Temperature: -20~180℃
- 线速度 Speeds: ≤20m/sec 软对硬(Soft VS Hard) ≤10m/sec 硬对硬(Hard VS Hard)
- 粘度 Viscosity: ≤1.0Pa.s(1000cp)软对硬(Soft VS Hard) ≤3.5Pa.s(3500cp)硬对硬(Hard VS Hard)

**材料 Materials(to DIN24960)**

- 辅助密封 Auxiliary Seal: P、E、V、M1
- 弹簧及其他结构件材料 Spring and Other Parts: F、G

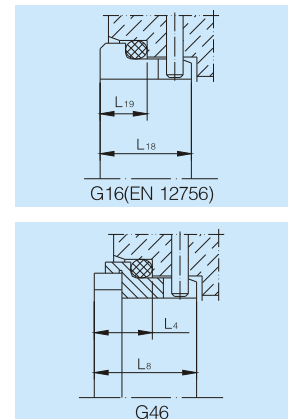
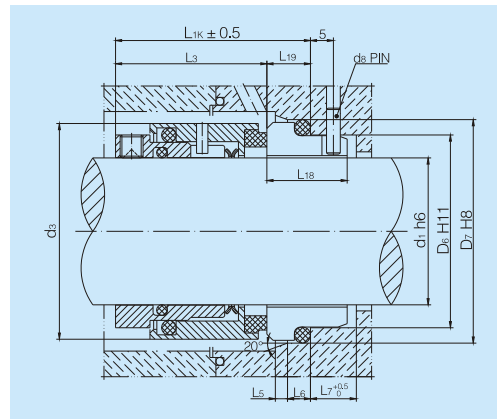

型号 Model	d1	d3	D6	D7	d8	L1k	L3	L4	L5	L6	L7	L8	L13	L18	L19
18	18	32	27	33	3	37.5	30.5	9.0	2.0	5	9.0	17.0	28.5	15.0	7.0
20	20	34	29	35	3	37.5	30.5	9.0	2.0	5	9.0	17.0	28.5	15.0	7.0
22	22	36	31	37	3	37.5	30.5	9.0	2.0	5	9.0	17.0	28.5	15.0	7.0
24	24	38	33	39	3	40.0	33.0	9.0	2.0	5	9.0	17.0	31.0	15.0	7.0
25	25	39	34	40	3	40.0	33.0	9.0	2.0	5	9.0	17.0	31.0	15.0	7.0
28	28	42	37	43	3	42.5	35.5	9.5	2.0	5	9.0	17.5	33.0	15.0	7.0
30	30	44	39	45	3	42.5	35.5	9.5	2.0	5	9.0	17.5	33.0	15.0	7.0
32	32	47	42	48	3	42.5	35.5	9.5	2.0	5	9.0	17.5	33.0	15.0	7.0
33	33	47	42	48	3	42.5	35.5	9.5	2.0	5	9.0	17.5	33.0	15.0	7.0
35	35	49	44	50	3	42.5	35.5	9.5	2.0	5	9.0	17.5	33.0	15.0	7.0
38	38	54	49	56	4	45.0	37.0	10.5	2.0	6	9.0	18.5	34.5	16.0	8.0
40	40	56	51	58	4	45.0	37.0	10.5	2.0	6	9.0	18.5	34.5	16.0	8.0
43	43	59	54	61	4	45.0	37.0	10.5	2.0	6	9.0	18.5	34.5	16.0	8.0
45	45	61	56	63	4	45.0	37.0	10.5	2.0	6	9.0	18.5	34.5	16.0	8.0
48	48	64	59	66	4	45.0	37.0	10.5	2.0	6	9.0	18.5	34.5	16.0	8.0
50	50	66	62	70	4	47.5	38.0	12.0	2.5	6	9.0	19.5	35.5	17.0	9.5
53	53	69	65	73	4	47.5	38.0	12.0	2.5	6	9.0	19.5	35.5	17.0	9.5
55	55	71	67	75	4	47.5	38.0	12.0	2.5	6	9.0	19.5	35.5	17.0	9.5
58	58	78	70	78	4	52.5	42.0	13.0	2.5	6	9.0	20.5	39.5	18.0	10.5
60	60	80	72	80	4	52.5	42.0	13.0	2.5	6	9.0	20.5	39.5	18.0	10.5
63	63	83	75	83	4	52.5	42.0	13.0	2.5	6	9.0	20.5	39.5	18.0	10.5
65	65	85	77	85	4	52.5	42.0	13.0	2.5	6	9.0	20.5	39.5	18.0	10.5
68	68	88	81	90	4	52.5	41.5	13.5	2.5	7	9.0	21.0	39.0	18.5	11.0
70	70	90	83	92	4	60.0	48.5	14.0	2.5	7	9.0	21.5	46.0	19.0	11.5
75	75	99	88	97	4	60.0	48.5	14.0	2.5	7	9.0	21.5	46.0	19.0	11.5
80	80	104	95	105	4	60.0	48.5	14.0	3.0	7	9.0	21.5	46.0	19.0	11.5
85	85	109	100	110	4	60.0	48.5	14.0	3.0	7	9.0	21.5	46.0	19.0	11.5
90	90	114	105	115	4	65.0	52.0	15.5	3.0	7	9.0	23.0	49.5	20.5	13.0
95	95	119	110	120	4	65.0	52.0	15.5	3.0	7	9.0	23.0	49.5	20.5	13.0
100	100	124	115	125	4	65.0	52.0	15.5	3.0	7	9.0	23.0	49.5	20.5	13.0